

- TOWN OF COLONIE STANDARD NOTES:**
1. THE APPLICANT SHALL COMPLY WITH ALL APPLICABLE FEDERAL, STATE, AND LOCAL LAWS, ORDINANCES, REGULATIONS, AND STANDARDS, INCLUDING BUT NOT LIMITED TO THE STATE ENVIRONMENTAL QUALITY REVIEW ACT (SEQDR) AND THE TOWN FLOOD PLANS PERMIT REGULATIONS, THE TOWN GRADING LAW, AND THE TOWN FLOOD PLANS MANAGEMENT.
 2. THE APPLICANT SHALL BEAR THE SOLE RESPONSIBILITY FOR ENSURING THAT ALL APPROVED PLANS AND SPECIFICATIONS COMPLY WITH ALL APPLICABLE LAWS, ORDINANCES, REGULATIONS, AND STANDARDS.
 3. NO CERTIFICATE OF OCCUPANCY SHALL BE ISSUED UNTIL ALL REQUIRED IMPROVEMENTS ARE SATISFACTORILY COMPLETED AND THE PLANNING AND ZONING DEPARTMENTS HAVE REVIEWED AND APPROVED THE PLANS AND SPECIFICATIONS TO THE BUILDING DEPARTMENT.
 4. THE APPLICANT SHALL BE RESPONSIBLE FOR KEEPING EXISTING PUBLIC HIGHWAYS AND ADJACENT LANDS FREE OF DEBRIS, SOIL, AND OTHER MATERIAL WHICH MAY BE DANGEROUS TO TRAVELERS AND NEIGHBORING PROPERTIES.
 5. ALL SITE LIGHTING SHALL BE DESIGNED AND INSTALLED SO AS NOT TO ILLUMINATE ADJACENT PROPERTIES OR HIGHWAYS.
 6. ALL PLANT MATERIALS INSTALLED PURSUANT TO THIS SITE DEVELOPMENT PLAN SHALL CONFORM TO THE AMERICAN STANDARD NURSERY STOCK (ANSI Z603.1-2006) STANDARD SPECIFICATION OF NURSERY STOCK (ANIS RECOMMENDS) STANDARD SPECIFICATION OF NURSERY STOCK (ANIS RECOMMENDS) WITH THE ACCEPTED INDUSTRY PRACTICE.
 7. NO PORTION OF THIS SITE SHALL BE USED FOR STORAGE OR DISPLAY OF ANY PRODUCT OR MATERIAL, OR FOR PARKING OF ANY VEHICLES, OR FOR THE STORAGE OF ANY MATERIALS, EXCEPT AS SPECIFICALLY NOTED ON THE PLANS.
 8. ALL REQUIRED EROSION CONTROL MEASURES SHALL BE INSTALLED IN ACCORDANCE WITH THE NEW YORK STATE STANDARDS & SPECIFICATIONS FOR EROSION & SEDIMENT CONTROL.

LANDS N/F
ALBANY COUNTY
L2558, P.863
TM#8-2-521-5
(AIRPORT)

LANDS N/F
ALBANY COUNTY
L2558, P.863
TM#8-2-521-5
(AIRPORT)

LANDS N/F
ALBANY COUNTY
L2558, P.863
TM#8-2-521-5
(AIRPORT)

LANDS N/F
ALBANY COUNTY
L2558, P.863
TM#8-2-521-5
(AIRPORT)

LANDS N/F
ALBANY COUNTY
L2558, P.863
TM#8-2-521-5
(AIRPORT)

LANDS N/F
ALBANY COUNTY
L2558, P.863
TM#8-2-521-5
(AIRPORT)

LANDS N/F
ALBANY COUNTY
L2558, P.863
TM#8-2-521-5
(AIRPORT)

LANDS N/F
ALBANY COUNTY
L2558, P.863
TM#8-2-521-5
(AIRPORT)

LANDS N/F
ALBANY COUNTY
L2558, P.863
TM#8-2-521-5
(AIRPORT)

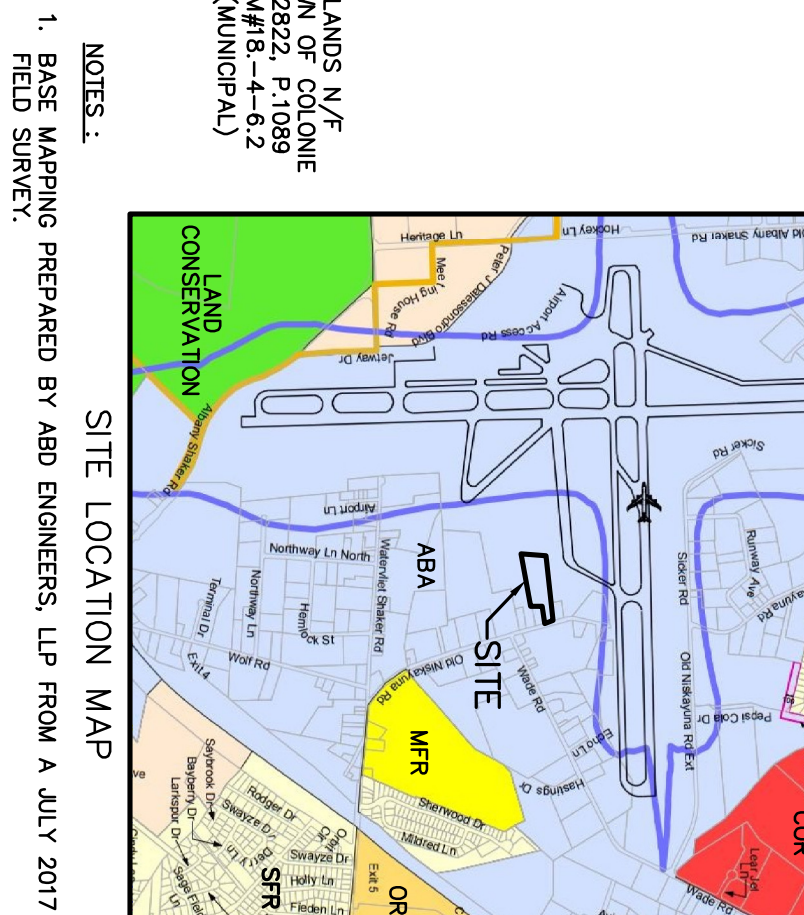
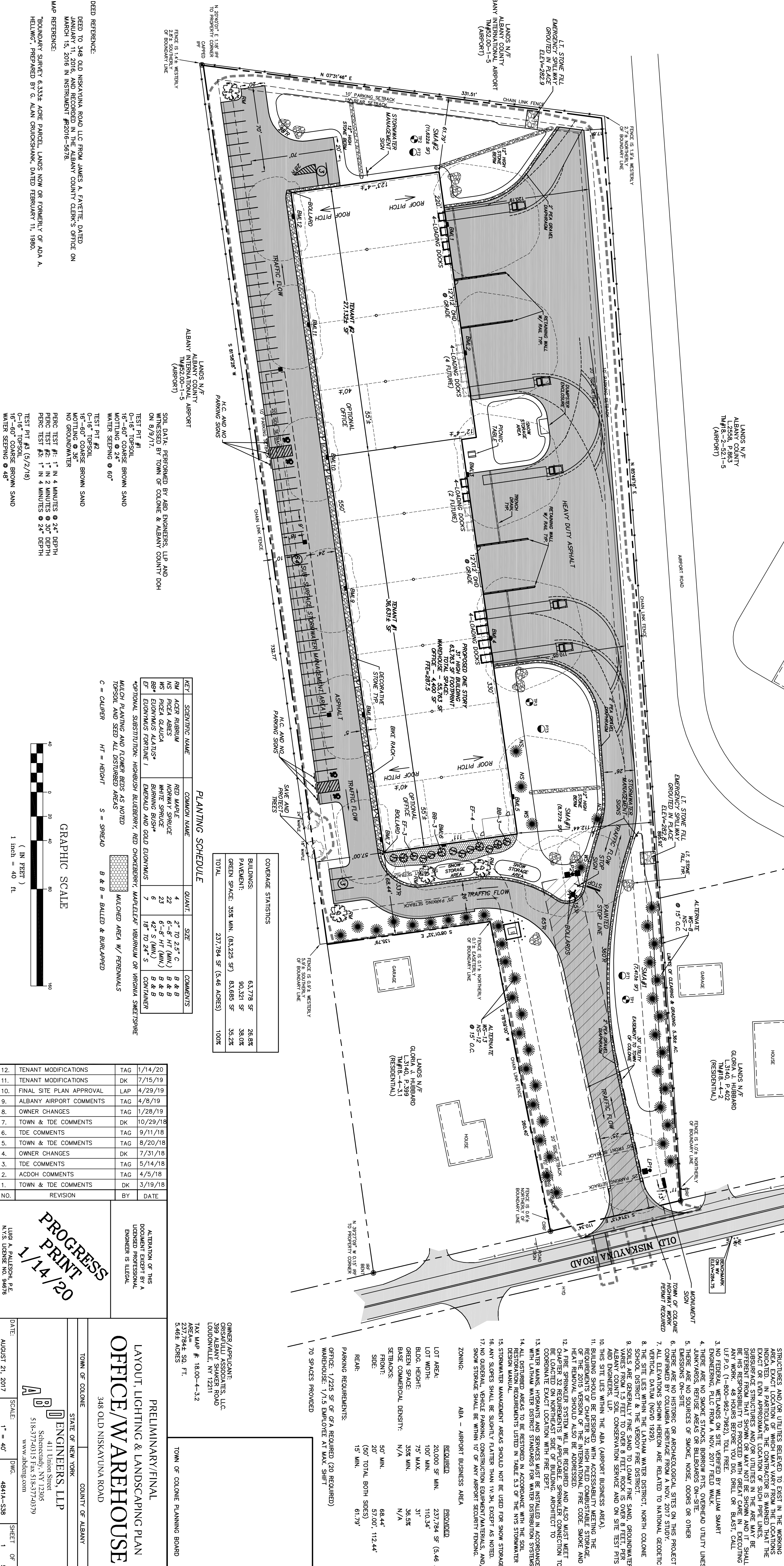

SITE LOCATION MAP

- NOTES:**
1. BASE MAPING PREPARED BY ABD ENGINEERS, LLP FROM A JULY 2017
 2. THE PLANS SHOW SOME KNOWN STRUCTURE ABOVEGROUND
 3. STRUCTURES AND/OR UTILITIES BELIEVED TO EXIST IN THE WORKING AREA. EXACT LOCATION OF WHICH MAY VARY FROM THE LOCATIONS INDICATED. IN PARTICULAR, THE CONTRACTOR IS WARNED THAT THE EXISTING UTILITIES ARE NOT SHOWN TO SCALE. THE CONTRACTOR SHALL BE RESPONSIBLE FOR VERIFYING THE LOCATION OF ALL UTILITIES AND SHALL BE RESPONSIBLE FOR PROCEEDING WITH GREAT CARE IN EXCUTTING ANY WORK. 48 HOURS BEFORE YOU DIG, DRILL OR BLAST CALL UTILITY: (1-800-882-7962), TOLL FREE BY WILLIAM SMART ENGINEERING, P.L.L.C. FROM A NOV. 2017 FIELD WALK.
 4. THERE ARE NO SMOKE STACKS, BORROW PITS, OVERHEAD UTILITY LINES, JUNKYARDS, REFUSE AREAS OR BILLBOARDS ON-SITE.
 5. THERE ARE NO SOURCES OF SMOKE, NOISE, ODORS OR OTHER EMISSIONS ON-SITE.
 6. THERE ARE NO HISTORIC OR ARCHAEOLOGICAL SITES ON THIS PROJECT AS DETERMINED BY COLUMBIA HERITAGE FROM A NOV. 2017 STUDY.
 7. VERTICAL DATA (KNOX 1929) ARE RELATED TO NATIONAL GEODETIC SCHOOL DISTRICT & THE VERBOY FIRE DISTRICT.
 8. THE SITE LIES WITHIN THE LATHAM WATER DISTRICT.
 9. SOILS ARE GENERALLY FINE SAND TO LOAMY FINE SAND, GROUNDWATER VARIES FROM 1.5 FEET TO OVER 8 FEET, ROCK IS OVER 8 FEET. PER CHAPTER 32 REQUIREMENTS IF APPLICABLE, SPRINKLER CONNECTION TO COORDINATE EXACT LOCATION WITH FIRE DEPT.
 10. THIS SITE LIES WITHIN THE ABA (AIRPORT BUSINESS AREA).
 11. BUILDING SHOULD BE DESIGNED WITH ACCESSIBILITY MEETING THE REQUIREMENTS OF CHAPTER 32, HIGH PILED COMBUSTIBLE STORAGE, HEAVY RENTALS SHOULD ALSO BE ADDRESSED, AND ALSO MUST MEET THE 2015 VERSION OF THE INTERNATIONAL FIRE CODE SMOKE AND CHAPTER 32 REQUIREMENTS IF APPLICABLE, SPRINKLER CONNECTION TO COORDINATE EXACT LOCATION WITH FIRE DEPT.
 12. WATER MAINS, HYDRANTS AND SERVICES MUST BE INSTALLED IN ACCORDANCE WITH LATHAM WATER DISTRICT STANDARDS FOR WATER DISTRIBUTION SYSTEMS.
 13. ALL DISTURBED AREAS TO BE RESTORED IN ACCORDANCE WITH THE SOIL DESIGN MANUAL.
 14. STORMWATER MANAGEMENT AREAS SHOULD NOT BE USED FOR SNOW STORAGE.
 15. ANY SLOPES SHALL BE SLIGHTLY FLATTER THAN 1V:3H, EXCEPT AS NOTED.
 16. NO GULLERS, VEHICLE PARKING, CONSTRUCTION EQUIPMENT/MATERIALS AND/OR SNOW STORAGE SHALL BE WITHIN 10' OF ANY AIRPORT SECURITY FENCING.

DEED REFERENCE:
DEED TO 348 OLD NISKAYUNA ROAD LLC FROM JAMES A. FAVETTE, DATED JANUARY 11, 2016, AND RECORDED IN THE ALBANY COUNTY CLERK'S OFFICE ON MARCH 15, 2016 IN INSTRUMENT #R2016-5978.
MAP REFERENCE:
"BOUNDARY SURVEY 6.3334 ACRE PARCEL, LANDS NOW OR FORMERLY OF ADA A. HELLMING," PREPARED BY G. ALAN GROSSKOPF, DATED FEBRUARY 11, 1980.

LANDS N/F
ALBANY COUNTY
TM#82.001-1-5
(AIRPORT)

LANDS N/F
ALBANY COUNTY
TM#82.001-1-5
(AIRPORT)

LANDS N/F
ALBANY COUNTY
TM#82.001-1-5
(AIRPORT)

LANDS N/F
ALBANY COUNTY
TM#82.001-1-5
(AIRPORT)

LANDS N/F
ALBANY COUNTY
TM#82.001-1-5
(AIRPORT)

LANDS N/F
ALBANY COUNTY
TM#82.001-1-5
(AIRPORT)

LANDS N/F
ALBANY COUNTY
TM#82.001-1-5
(AIRPORT)

LANDS N/F
ALBANY COUNTY
TM#82.001-1-5
(AIRPORT)

LANDS N/F
ALBANY COUNTY
TM#82.001-1-5
(AIRPORT)

LANDS N/F
ALBANY COUNTY
TM#82.001-1-5
(AIRPORT)

LANDS N/F
ALBANY COUNTY
TM#82.001-1-5
(AIRPORT)

LANDS N/F
ALBANY COUNTY
TM#82.001-1-5
(AIRPORT)

LANDS N/F
ALBANY COUNTY
TM#82.001-1-5
(AIRPORT)

LANDS N/F
ALBANY COUNTY
TM#82.001-1-5
(AIRPORT)

LANDS N/F
ALBANY COUNTY
TM#82.001-1-5
(AIRPORT)

LANDS N/F
ALBANY COUNTY
TM#82.001-1-5
(AIRPORT)

LANDS N/F
ALBANY COUNTY
TM#82.001-1-5
(AIRPORT)

LANDS N/F
ALBANY COUNTY
TM#82.001-1-5
(AIRPORT)

LANDS N/F
ALBANY COUNTY
TM#82.001-1-5
(AIRPORT)

LANDS N/F
ALBANY COUNTY
TM#82.001-1-5
(AIRPORT)

LANDS N/F
ALBANY COUNTY
TM#82.001-1-5
(AIRPORT)

LANDS N/F
ALBANY COUNTY
TM#82.001-1-5
(AIRPORT)

LANDS N/F
ALBANY COUNTY
TM#82.001-1-5
(AIRPORT)

LANDS N/F
ALBANY COUNTY
TM#82.001-1-5
(AIRPORT)

LANDS N/F
ALBANY COUNTY
TM#82.001-1-5
(AIRPORT)

LANDS N/F
ALBANY COUNTY
TM#82.001-1-5
(AIRPORT)

LANDS N/F
ALBANY COUNTY
TM#82.001-1-5
(AIRPORT)

LANDS N/F
ALBANY COUNTY
TM#82.001-1-5
(AIRPORT)

LANDS N/F
ALBANY COUNTY
TM#82.001-1-5
(AIRPORT)

LANDS N/F
ALBANY COUNTY
TM#82.001-1-5
(AIRPORT)

LANDS N/F
ALBANY COUNTY
TM#82.001-1-5
(AIRPORT)

LANDS N/F
ALBANY COUNTY
TM#82.001-1-5
(AIRPORT)

LANDS N/F
ALBANY COUNTY
TM#82.001-1-5
(AIRPORT)

LANDS N/F
ALBANY COUNTY
TM#82.001-1-5
(AIRPORT)

LANDS N/F
ALBANY COUNTY
TM#82.001-1-5
(AIRPORT)

LANDS N/F
ALBANY COUNTY
TM#82.001-1-5
(AIRPORT)

LANDS N/F
ALBANY COUNTY
TM#82.001-1-5
(AIRPORT)

LANDS N/F
ALBANY COUNTY
TM#82.001-1-5
(AIRPORT)

LANDS N/F
ALBANY COUNTY
TM#82.001-1-5
(AIRPORT)

LANDS N/F
ALBANY COUNTY
TM#82.001-1-5
(AIRPORT)

LANDS N/F
ALBANY COUNTY
TM#82.001-1-5
(AIRPORT)

LANDS N/F
ALBANY COUNTY
TM#82.001-1-5
(AIRPORT)

LANDS N/F
ALBANY COUNTY
TM#82.001-1-5
(AIRPORT)

LANDS N/F
ALBANY COUNTY
TM#82.001-1-5
(AIRPORT)

LANDS N/F
ALBANY COUNTY
TM#82.001-1-5
(AIRPORT)

LANDS N/F
ALBANY COUNTY
TM#82.001-1-5
(AIRPORT)

LANDS N/F
ALBANY COUNTY
TM#82.001-1-5
(AIRPORT)

LANDS N/F
ALBANY COUNTY
TM#82.001-1-5
(AIRPORT)

LANDS N/F
ALBANY COUNTY
TM#82.001-1-5
(AIRPORT)

LANDS N/F
ALBANY COUNTY
TM#82.001-1-5
(AIRPORT)

LANDS N/F
ALBANY COUNTY
TM#82.001-1-5
(AIRPORT)

LANDS N/F
ALBANY COUNTY
TM#82.001-1-5
(AIRPORT)

LANDS N/F
ALBANY COUNTY
TM#82.001-1-5
(AIRPORT)

LANDS N/F
ALBANY COUNTY
TM#82.001-1-5
(AIRPORT)

LANDS N/F
ALBANY COUNTY
TM#82.001-1-5
(AIRPORT)

LANDS N/F
ALBANY COUNTY
TM#82.001-1-5
(AIRPORT)

LANDS N/F
ALBANY COUNTY
TM#82.001-1-5
(AIRPORT)

LANDS N/F
ALBANY COUNTY
TM#82.001-1-5
(AIRPORT)

LANDS N/F
ALBANY COUNTY
TM#82.001-1-5
(AIRPORT)

LANDS N/F
ALBANY COUNTY
TM#82.001-1-5
(AIRPORT)

LANDS N/F
ALBANY COUNTY
TM#82.001-1-5
(AIRPORT)

LANDS N/F
ALBANY COUNTY
TM#82.001-1-5
(AIRPORT)

LANDS N/F
ALBANY COUNTY
TM#82.001-1-5
(AIRPORT)

LANDS N/F
ALBANY COUNTY
TM#82.001-1-5
(AIRPORT)

LANDS N/F
ALBANY COUNTY
TM#82.001-1-5
(AIRPORT)

LANDS N/F
ALBANY COUNTY
TM#82.001-1-5
(AIRPORT)

LANDS N/F
ALBANY COUNTY
TM#82.001-1-5
(AIRPORT)

LANDS N/F
ALBANY COUNTY
TM#82.001-1-5
(AIRPORT)

LANDS N/F
ALBANY COUNTY
TM#82.001-1-5
(AIRPORT)

LANDS N/F
ALBANY COUNTY
TM#82.001-1-5
(AIRPORT)

LANDS N/F
ALBANY COUNTY
TM#82.001-1-5
(AIRPORT)

LANDS N/F
ALBANY COUNTY
TM#82.001-1-5
(AIRPORT)

LANDS N/F
ALBANY COUNTY
TM#82.001-1-5
(AIRPORT)

LANDS N/F
ALBANY COUNTY
TM#82.001-1-5
(AIRPORT)

LANDS N/F
ALBANY COUNTY
TM#82.001-1-5
(AIRPORT)

LANDS N/F
ALBANY COUNTY
TM#82.001-1-5
(AIRPORT)

LANDS N/F
ALBANY COUNTY
TM#82.001-1-5
(AIRPORT)

LANDS N/F
ALBANY COUNTY
TM#82.001-1-5
(AIRPORT)

LANDS N/F
ALBANY COUNTY
TM#82.001-1-5
(AIRPORT)

LANDS N/F
ALBANY COUNTY
TM#82.001-1-5
(AIRPORT)

LANDS N/F
ALBANY COUNTY
TM#82.001-1-5
(AIRPORT)

LANDS N/F
ALBANY COUNTY
TM#82.001-1-5
(AIRPORT)

LANDS N/F
ALBANY COUNTY
TM#82.001-1-5
(AIRPORT)

LANDS N/F
ALBANY COUNTY
TM#82.001-1-5
(AIRPORT)

LANDS N/F
ALBANY COUNTY
TM#82.001-1-5
(AIRPORT)

LANDS N/F
ALBANY COUNTY
TM#82.001-1-5
(AIRPORT)

LANDS N/F
ALBANY COUNTY
TM#82.001-1-5
(AIRPORT)

LANDS N/F
ALBANY COUNTY
TM#82.001-1-5
(AIRPORT)

LANDS N/F
ALBANY COUNTY
TM#82.001-1-5
(AIRPORT)

LANDS N/F
ALBANY COUNTY
TM#82.001-1-5
(AIRPORT)

LANDS N/F
ALBANY COUNTY
TM#82.001-1-5
(AIRPORT)

LANDS N/F
ALBANY COUNTY
TM#82.001-1-5
(AIRPORT)

LANDS N/F
ALBANY COUNTY
TM#82.001-1-5
(AIRPORT)

LANDS N/F
ALBANY COUNTY
TM#82.001-1-5
(AIRPORT)

LANDS N/F
ALBANY COUNTY
TM#82.001-1-5
(AIRPORT)

LANDS N/F
ALBANY COUNTY
TM#82.001-1-5
(AIRPORT)

LANDS N/F
ALBANY COUNTY
TM#82.001-1-5
(AIRPORT)

LANDS N/F
ALBANY COUNTY
TM#82.001-1-5
(AIRPORT)

LANDS N/F
ALBANY COUNTY
TM#82.001-1-5
(AIRPORT)

LANDS N/F
ALBANY COUNTY
TM#82.001-1-5
(AIRPORT)

LANDS N/F
ALBANY COUNTY
TM#82.001-1-5
(AIRPORT)

LANDS N/F
ALBANY COUNTY
TM#82.001-1-5
(AIRPORT)

LANDS N/F
ALBANY COUNTY
TM#82.001-1-5
(AIRPORT)

LANDS N/F
ALBANY COUNTY
TM#82.001-1-5
(AIRPORT)

LANDS N/F
ALBANY COUNTY
TM#82.001-1-5
(AIRPORT)

LANDS N/F
ALBANY COUNTY
TM#82.001-1-5
(AIRPORT)

LANDS N/F
ALBANY COUNTY
TM#82.001-1-5
(AIRPORT)

LANDS N/F
ALBANY COUNTY
TM#82.001-1-5
(AIRPORT)

LANDS N/F
ALBANY COUNTY
TM#82.001-1-5
(AIRPORT)

LANDS N/F
ALBANY COUNTY
TM#82.001-1-5
(AIRPORT)

LANDS N/F
ALBANY COUNTY
TM#82.001-1-5
(AIRPORT)

LANDS N/F
ALBANY COUNTY
TM#82.001-1-5
(AIRPORT)

LANDS N/F
ALBANY COUNTY
TM#82.001-1-5
(AIRPORT)

LANDS N/F
ALBANY COUNTY
TM#82.001-1-5
(AIRPORT)

LANDS N/F
ALBANY COUNTY
TM#82.001-1-5
(AIRPORT)

LANDS N/F
ALBANY COUNTY
TM#82.001-1-5
(AIRPORT)

LANDS N/F
ALBANY COUNTY
TM#82.001-1-5
(AIRPORT)

LANDS N/F
ALBANY COUNTY
TM#82.001-1-5
(AIRPORT)

LANDS N/F
ALBANY COUNTY
TM#82.001-1-5
(AIRPORT)

LANDS N/F
ALBANY COUNTY
TM#82.001-1-5
(AIRPORT)

LANDS N/F
ALBANY COUNTY
TM#82.001-1-5
(AIRPORT)

LANDS N/F
ALBANY COUNTY
TM#82.001-1-5
(AIRPORT)

LANDS N/F
ALBANY COUNTY
TM#82.001-1-5
(AIRPORT)

LANDS N/F
ALBANY COUNTY
TM#82.001-1-5
(AIRPORT)

LANDS N/F
ALBANY COUNTY
TM#82.001-1-5
(AIRPORT)

LANDS N/F
ALBANY COUNTY
TM#82.001-1-5
(AIRPORT)

LANDS N/F
ALBANY COUNTY
TM#82.001-1-5
(AIRPORT)

LANDS N/F
ALBANY COUNTY
TM#82.001-1-5
(AIRPORT)

LANDS N/F
ALBANY COUNTY
TM#82.001-1-5
(AIRPORT)

LANDS N/F
ALBANY COUNTY
TM#82.001-1-5
(AIRPORT)

LANDS N/F
ALBANY COUNTY
TM#82.001-1-5
(AIRPORT)

LANDS N/F
ALBANY COUNTY
TM#82.001-1-5
(AIRPORT)

LANDS N/F
ALBANY COUNTY
TM#82.001-1-5
(AIRPORT)

LANDS N/F
ALBANY COUNTY
TM#82.001-1-5
(AIRPORT)

LANDS N/F
ALBANY COUNTY
TM#82.001-1-5
(AIRPORT)

LANDS N/F
ALBANY COUNTY
TM#82.001-1-5
(AIRPORT)

LANDS N/F
ALBANY COUNTY
TM#82.001-1-5
(AIRPORT)

LANDS N/F
ALBANY COUNTY
TM#82.001-1-5
(AIRPORT)

LANDS N/F
ALBANY COUNTY
TM#82.001-1-5
(AIRPORT)

LANDS N/F
ALBANY COUNTY
TM#82.001-1-5
(AIRPORT)

LANDS N/F
ALBANY COUNTY
TM#82.001-1-5
(AIRPORT)

LANDS N/F
ALBANY COUNTY
TM#82.001-1-5
(AIRPORT)

LANDS N/F
ALBANY COUNTY
TM#82.001-1-5
(AIRPORT)

LANDS N/F
ALBANY COUNTY
TM#82.001-1-5
(AIRPORT)

LANDS N/F
ALBANY COUNTY
TM#82.001-1-5
(AIRPORT)

LANDS N/F
ALBANY COUNTY
TM#82.001-1-5
(AIRPORT)

LANDS N/F
ALBANY COUNTY
TM#82.001-1-5
(AIRPORT)

LANDS N/F
ALBANY COUNTY
TM#82.001-1-5
(AIRPORT)

LANDS N/F
ALBANY COUNTY
TM#82.001-1-5
(AIRPORT)

LANDS N/F
ALBANY COUNTY
TM#82.001-1-5
(AIRPORT)